

## PROCEDURES IN CASE OF CHEMICAL MUNITION CATCH

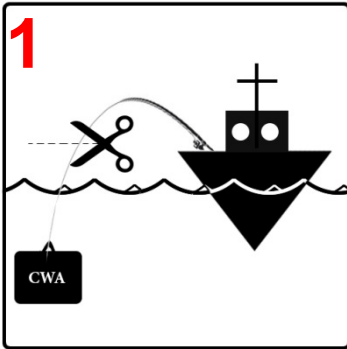

1  
the equipment should be cut off as quickly as possible

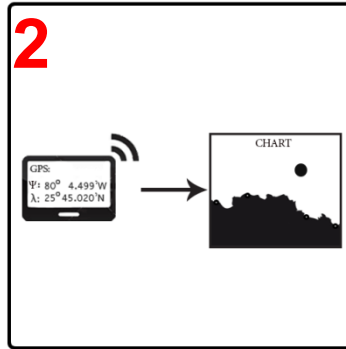

2  
specify the position of dumping the equipment and write it down

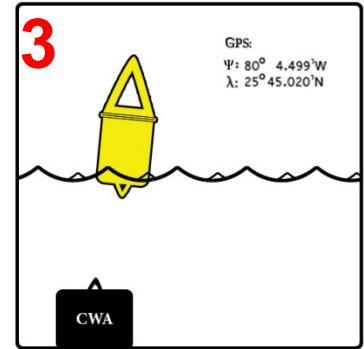

3  
the place of dumping should be marked with a yellow buoy and reported

## PROCEDURES IN CASE OF EXTRACTION OF CHEMICAL MUNITION

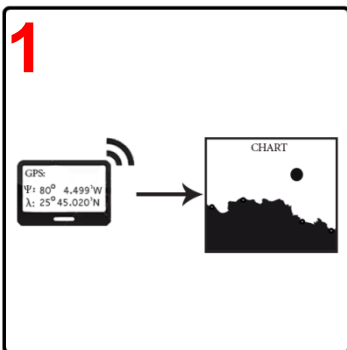

1  
specify the position of dumping the equipment and write it down

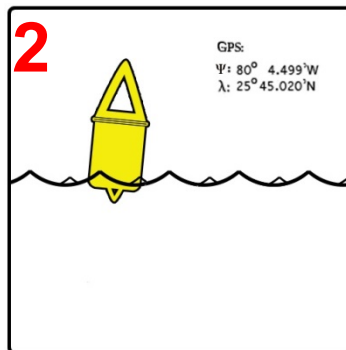

2  
the place of extraction should be marked with a yellow buoy

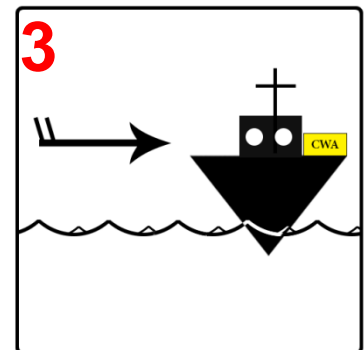

3  
steer the vessel in such a way that contaminated places remain lee side

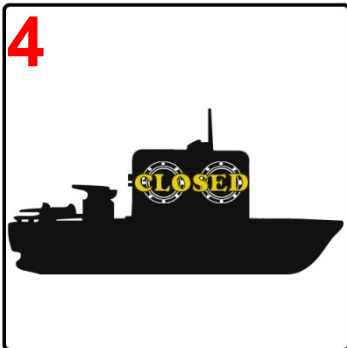

4  
close all the openings and hatches



5  
contact the nearest emergency point, giving the description of extracted objects

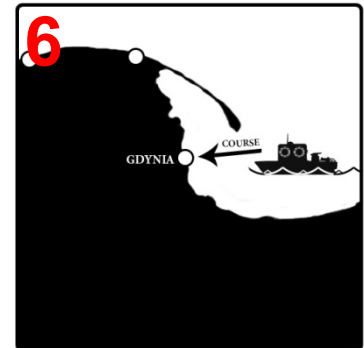

6  
direct the vessel to the nearest port

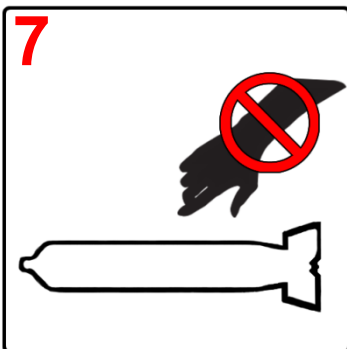

7  
do not touch the contaminated parts of the vessel nor the fishing equipment

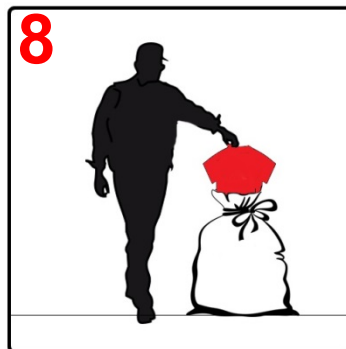

8  
take contaminated clothing off immediately and put it into plastic bags and secure it airtight



9  
stay on the radio watch for further instructions